

## CP X-2 L1

for LA1  
(osłony do LA1)

- (GB) Mounting instructions
- (DE) Montageanleitung
- (SI) Navodilo za montažo
- (PL) Instrukcje montażu
- (HR) Upute za montažu
- (CZ) Montážní návod
- (SK) Navod na montáž
- (HU) Szerelési utmutató
- (LT) Montavimo instrukcija
- (RU) Инструкция за монтаж
- (LV) Montāžas instrukcija
- (EST) Paigaldusjuhend

CP 1-2 L1



CP 2-2 L1

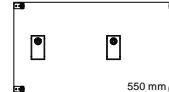

CP 1.4-2 L1

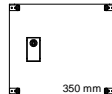

CP 3-2 L1

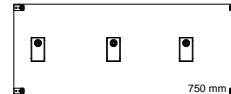

CP 2-2 L1

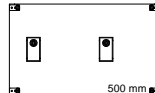

CP 3.8-2 L1

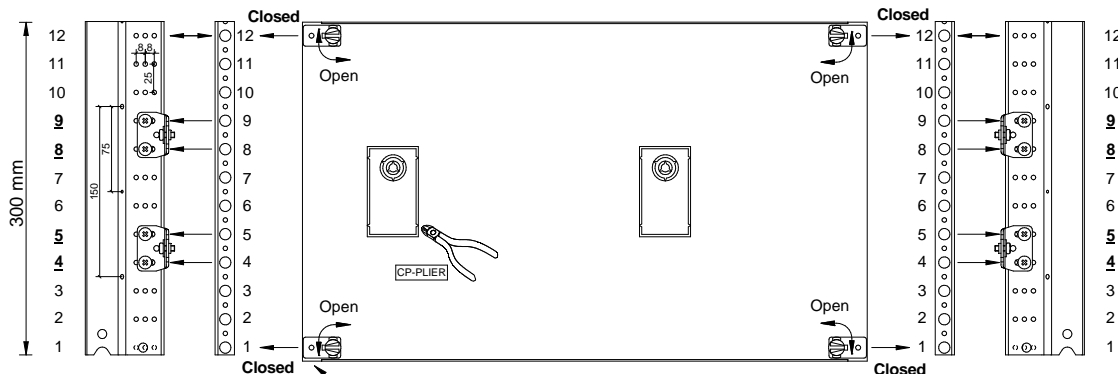
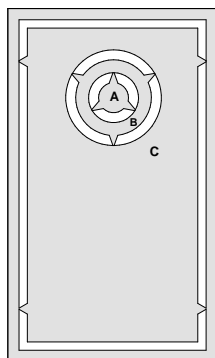
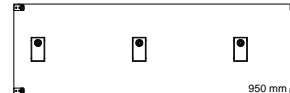

- Position 1** - with RO LA1 - cut out / remove A, B  
(z RO LA1 wyciąć / usunąć A, B)
- Position 2** - with ROD LA1,2 - cut out / remove A, B, C  
(z ROD LA1,2 wyciąć / usunąć A, B, C)
- Position 3** - with RO LA1 - cut out / remove A, B, C  
(z RO LA1 wyciąć / usunąć A, B, C)
- Position 4** - with ROD LA1,2 - cut out / remove A  
(z ROD LA1,2 wyciąć / usunąć A)

Position 1				
No.	Type ETI	Name	Pcs.	
1	LG-V5	Support	4	
2	AST 4.8x9.5	Tapping screw	8	
3	AW-RE 5	Washer M5 DIN9021 Zn	4	
4	AS-C 5x10	Screw M5x10 DIN7985 Zn	4	

Position 2 and 3				
No.	Type ETI	Name	Pcs.	
1	LG-V	Support	4	
2	AST 4.8x9.5	Tapping screw	8	
3	AW-RE 5	Washer M5 DIN9021 Zn	4	
4	AS-C 5x10	Screw M5x10 DIN7985 Zn	4	

Hole-position marker  
**left-down**  
(Otwór-znacznik pozycji  
lewy dolny róg)

Screwdriver flat-blade  
(Wkrętak płaski)

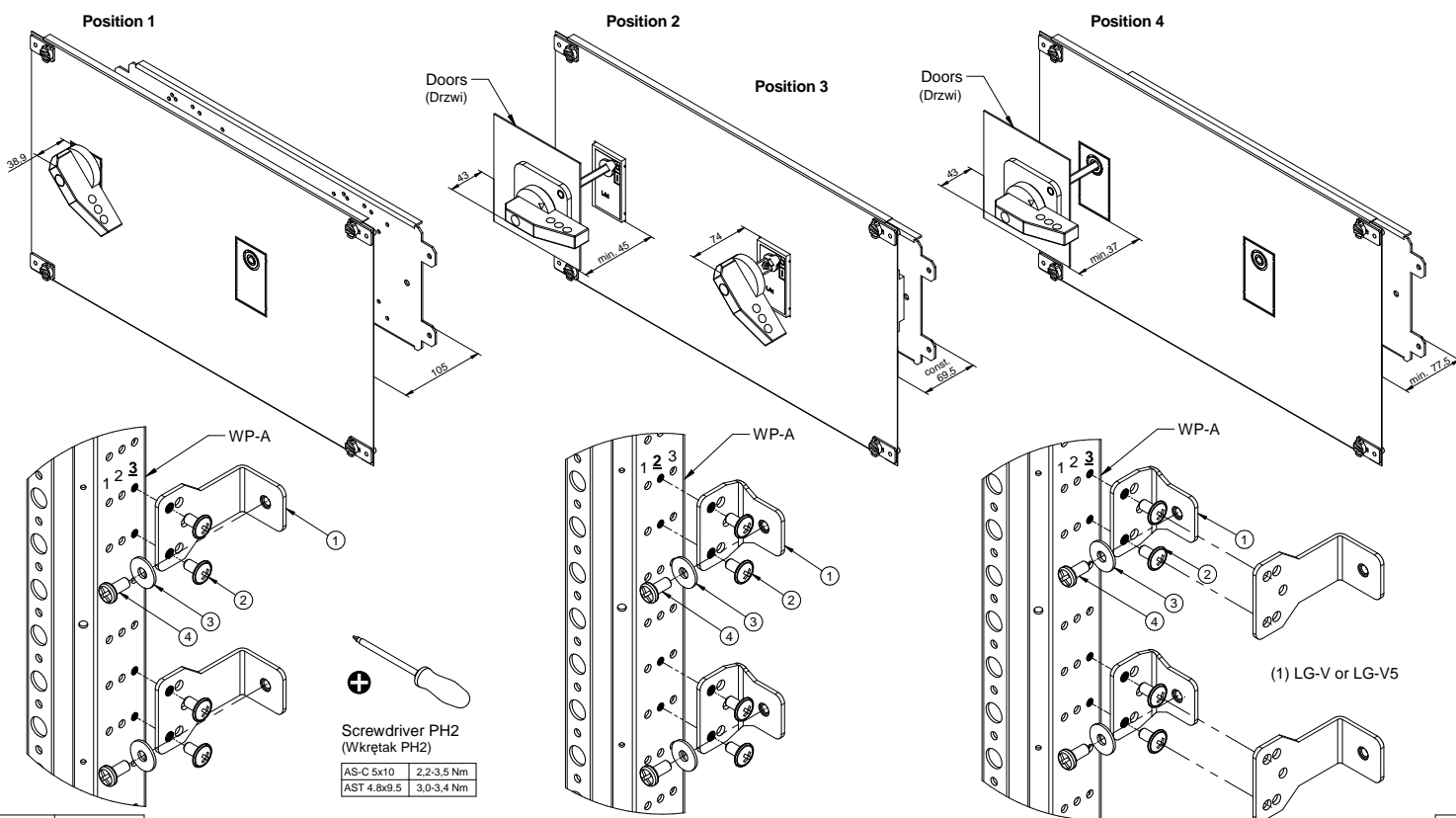

Screwdriver PH2  
(Wkrętak PH2)

AS-C 5x10	2.2-3.5 Nm
AST 4.8x9.5	3.0-3.4 Nm

CP X-2 L1

No.	Type ETI	Name	Pcs.
1	AS-C 4x16	Screw M4x16 DIN7985 Zn	4
2	AW-S 4	Washer spring M4 DIN127 Zn	8
3	AW-R 4	Washer M4 DIN126 Zn	4
4	AN-H 4	Nut M4 DIN934 Zn	4

Switch disconnectors montage in specified holes (black points)

(Rozłączniki montować w otworach oznaczonych czarnymi punktami)

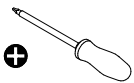
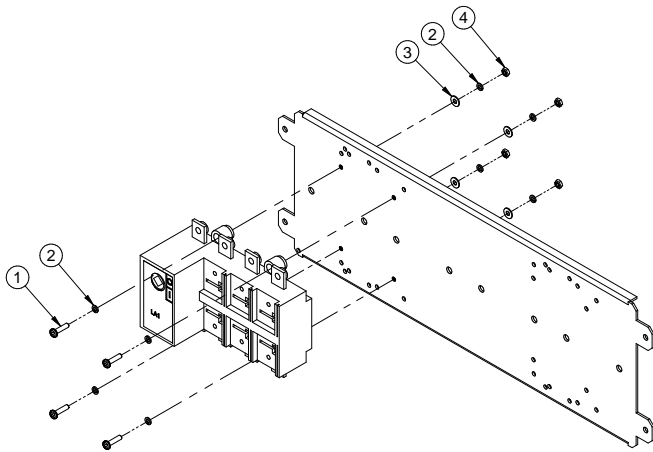

Screwdriver PH2  
(Wkrętak PH2)

AS-C 4x16 | 1,7-2,2 Nm

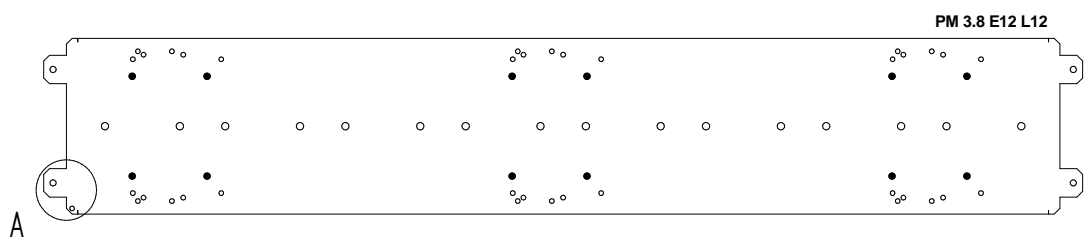
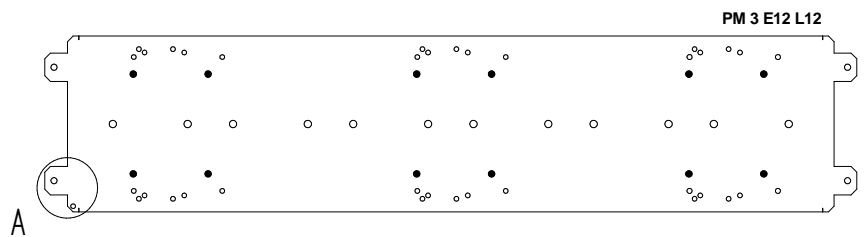
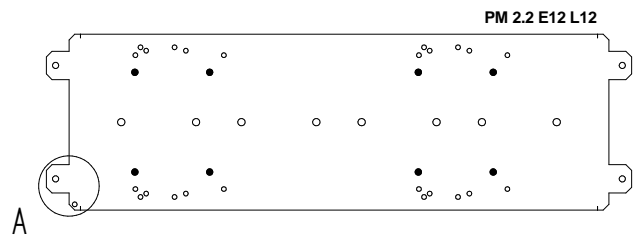
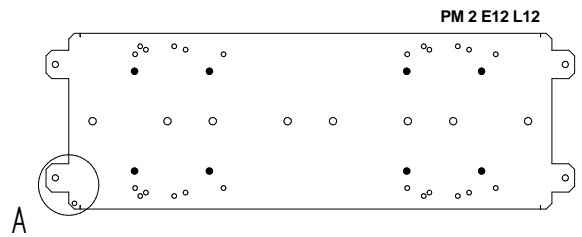
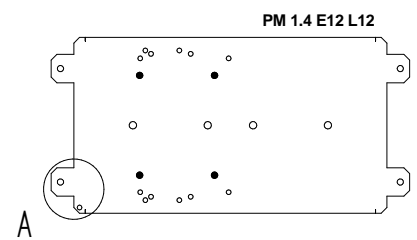
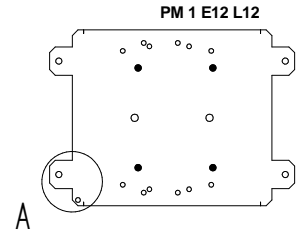

DETAIL A

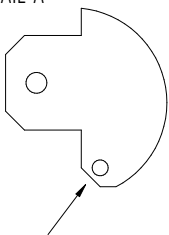

Hole-position marker  
**left-down**  
(Otwór-znacznik pozycji  
**lewy dolny róg**)